



Brindlestone Close

Hunsbury Meadows, Northampton

oriordanbond
SALES & LETTINGS



Brindlestone Close

Hunsbury Meadows

NN4 9QQ

OFFERS OVER £360,000

A well presented three bedroom detached family home, situated in a cul-de-sac, within the popular area of Hunsbury Meadows. This property offers extended and versatile accommodation over two floors.

Entrance hall with access to a study/playroom/family room, sitting room, kitchen/dining room with integrated appliances and a large conservatory with under floor heating and an insulated roof. There is also an inner hall with stairs leading to the first floor and a cloakroom/WC. To the first floor is access to the loft space, an airing cupboard with a re-fitted combination boiler, doors to three ample bedrooms with en-suite facilities to the main bedroom and a separate family bathroom. Outside, the property occupies an enviable corner plot with block paved driveway for several cars and a good size private rear garden offering a lawn with planted borders, an artificial lawn area with canopy over and timber fencing to enclose. Further benefits include uPVC double glazing and gas radiator heating. (B/1123/L)

Additional information

- Council Tax Band: C
- Energy Efficiency Rating: C

Viewing

Viewing strictly by appointment – details below

Disclaimer

O'Riordan Bond Estate Agents Limited has not tested apparatus, equipment, fittings or services and so cannot verify they are in working order. The buyer is advised to obtain verification from their solicitor or surveyor.

O'Riordan Bond Hunsbury Sales

01604 706007

hunsbury@oriordanbond.co.uk

GROUND FLOOR

1ST FLOOR

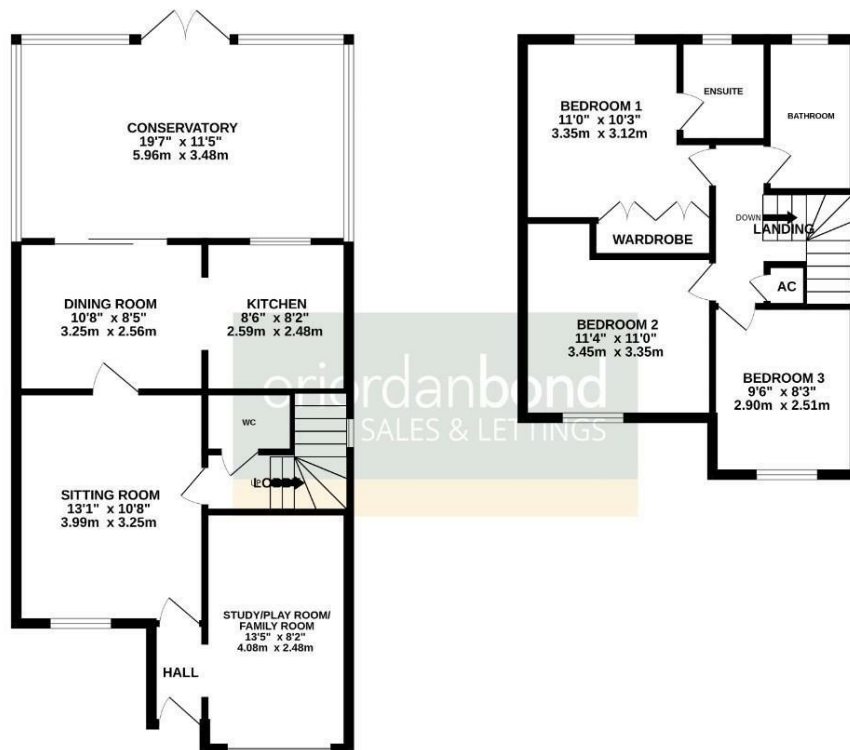

TOTAL FLOOR AREA: 1123 sq.ft. (104.3 sq.m.) approx.
Whilst every effort has been made to ensure the accuracy of the floorplan contained here, measurements of doors, windows, rooms and any other items are approximate and no responsibility is taken for any error, omission or misstatement. This plan is for illustrative purposes only and should be used as such by any prospective purchaser. The services, systems and appliances shown have not been tested and no guarantee as to their operability or efficiency can be given.
Made with Metagame C33026

